

■カラー鋼板(ロールフオーミング)

St155タイプ 155F型 働き巾155^{+0.8}mm t=0.5
(目地ありタイプ)

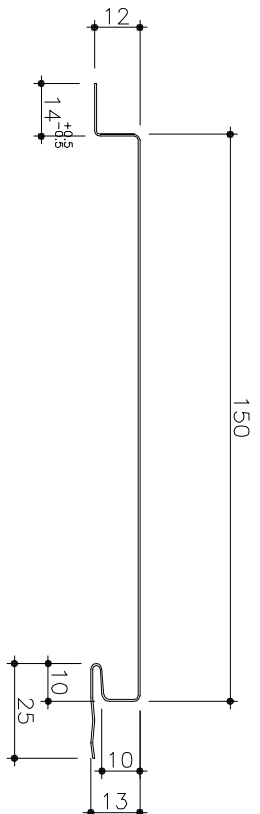

St155タイプ 150F型 働き巾150^{+0.8}mm t=0.5
(目地なしタイプ)

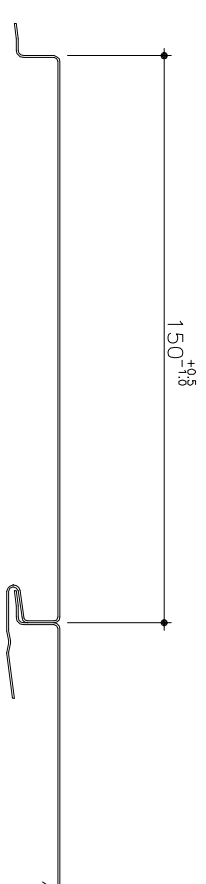
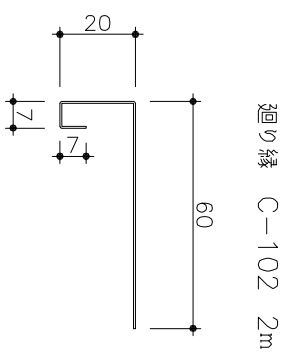
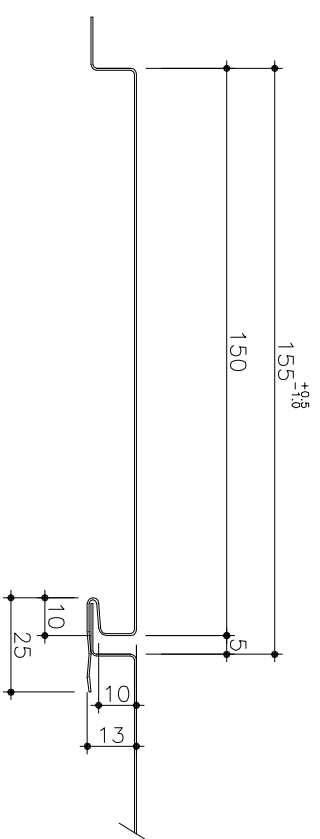
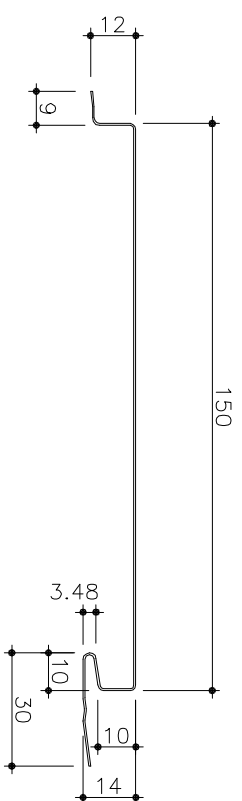

廻り縁 C-101 2m

水切 C-202 2m

腰水切り C-250 2m

H型接続 C-400 2m

捨て板 C-5 2m

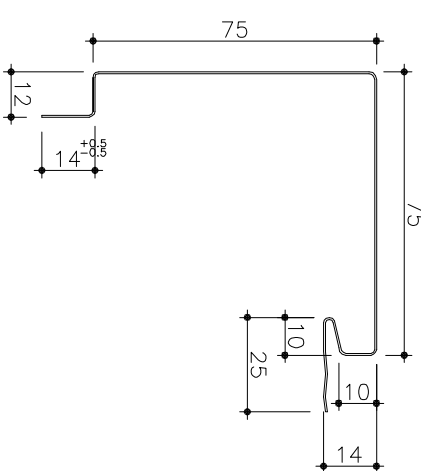
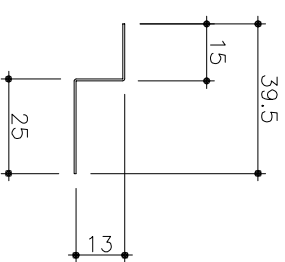
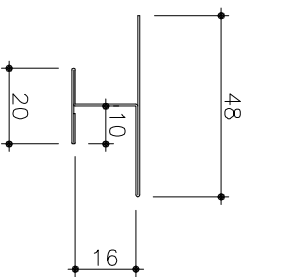
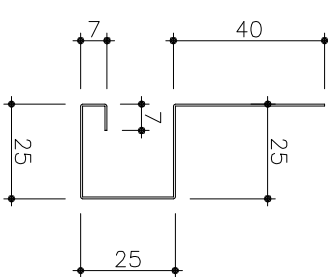
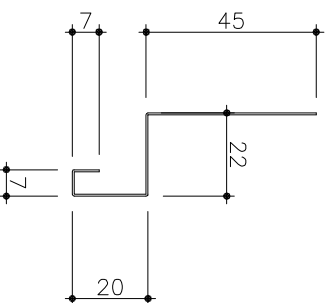
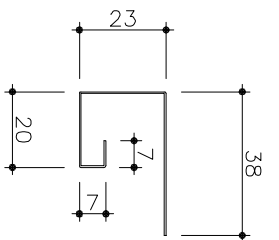

笠木 (C-145) 2m

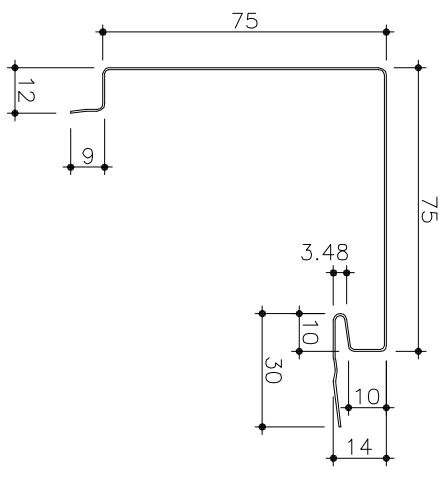

入隅 (C-304) 2m
(目地ありタイプ)

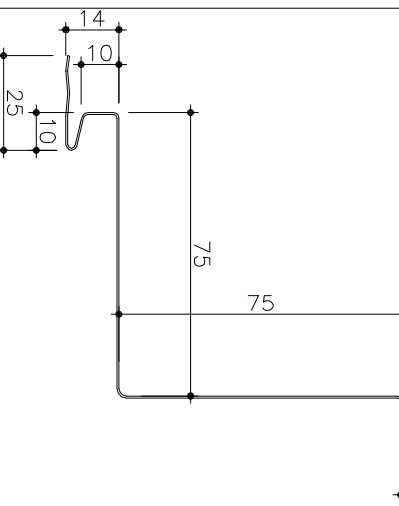

入隅 (C-304) 2m
(目地なしタイプ)

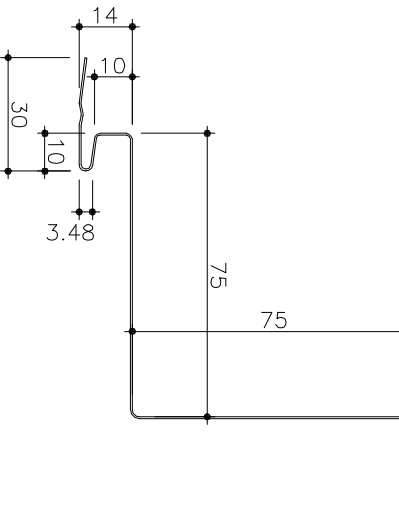

横張用出隅 (C-310) 2m

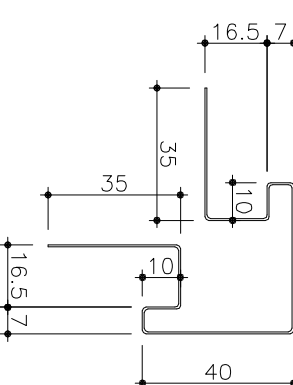

横張用入隅 (C-311) 2m

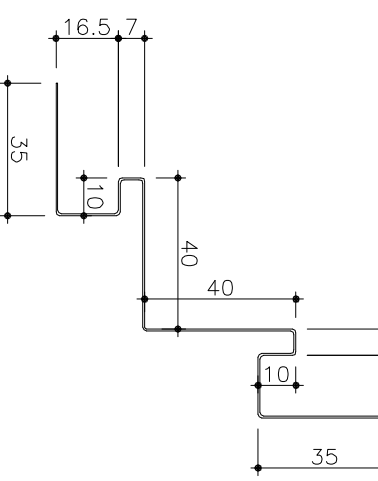

カラー鋼板F型スパン・付属品

St155タイプ

断面形状寸法図

Scale : 1/2



難波金属株式会社